

DCA Meadowlands Formal Garden

An elegant retreat, perfect for cocktail parties, weddings, luncheons and more, the DCA formal garden was designed by Ellen Biddle Shipman, named the “Dean of American Women Landscape Architects” by *House & Garden* magazine. All DCA rental rooms look out to this garden, with access from first floor rooms available through French doors. Guests may additionally enter and exit the garden from our spacious parking area.

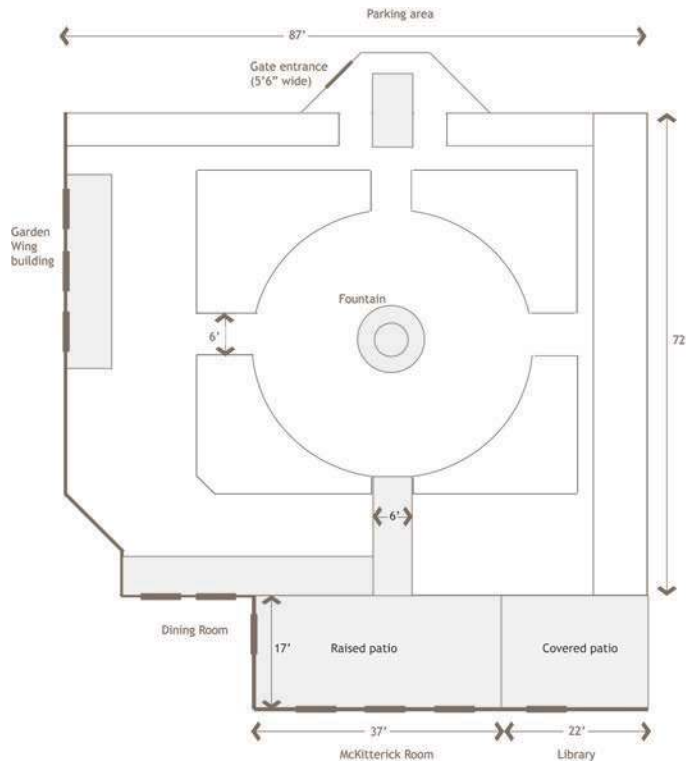

Seating capacity

Auditorium seating	250
Standing reception	400

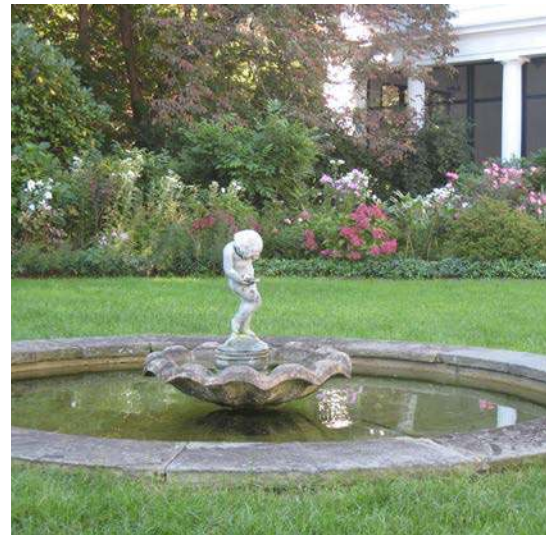

Contact Us

For further information or a tour of the estate, please contact Laura Boulton, our Catered Events Coordinator, at events@dariendca.org or 203-655-9050 extension 12.